

# SPECIFICATION FOR APPROVAL

|                   |                               |      |   |
|-------------------|-------------------------------|------|---|
| Product Name      | RADIAL CHOKE COIL (LEAD FREE) | Page | 1 |
| Tai-Tech Part No. | S0606-1 STAND-OFF SERIES      |      |   |

## 1. CONFIGURATION & DIMENSIONS :

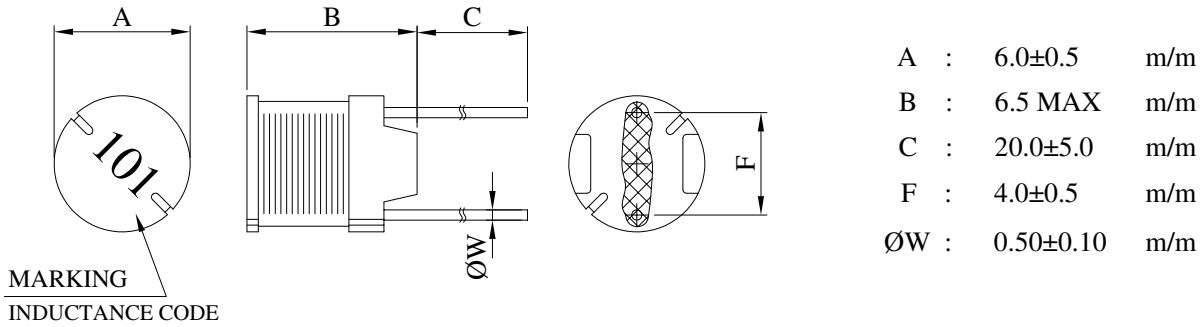

## 2. SCHEMATIC DIAGRAM :

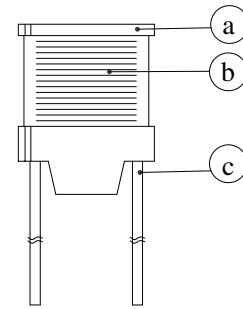
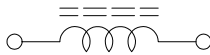

## 3. MATERIALS :

| NO. | DESCRIPTION | SPECIFICATION         | REMARK |
|-----|-------------|-----------------------|--------|
| a.  | CORE        | DR FERRITE CORE       |        |
| b.  | WIRE        | ENAMELLED COPPER WIRE |        |
| c.  | LEAD        | TINNED COPPER WIRE    |        |
| d.  | ADHESIVE    | EPOXY                 |        |

## 4. GENERAL SPECIFICATION :

- a. THE INDUCTANCE DROP AT RATED CURRENT IS 10% MAX.
- b. TEMP. RISE : 40°C MAX. AT RATED CURRENT.
- c. STORAGE TEMP. : -40°C ----- +125°C
- d. OPERATING TEMP. : -25°C ----- +85°C



**RoHS Compliant**

*NOTE : Specifications subject to change without notice. Please check our website for latest information.*

04.09.2006



**TAI-TECH ADVANCED ELECTRONICS (S) PTE LTD**

# SPECIFICATION FOR APPROVAL

|                   |                               |      |   |
|-------------------|-------------------------------|------|---|
| Product Name      | RADIAL CHOKE COIL (LEAD FREE) | Page | 2 |
| Tai-Tech Part No. | S0606-1 STAND-OFF SERIES      |      |   |

## 5. ELECTRICAL CHARACTERISTICS :

| PART NO.         | INDUCTANCE<br>( $\mu$ H) | TEST<br>FREQ.<br>(HZ) | RDC<br>( Ohm )<br>MAX | IDC<br>( A )<br>MAX |
|------------------|--------------------------|-----------------------|-----------------------|---------------------|
| S0606-220K1R2-1F | 22 $\pm$ 10%             | 2.52M                 | 0.11                  | 1.27                |
| S0606-270K1R1-1F | 27 $\pm$ 10%             | 2.52M                 | 0.14                  | 1.14                |
| S0606-330K1R0-1F | 33 $\pm$ 10%             | 2.52M                 | 0.17                  | 1.03                |
| S0606-390KR95-1F | 39 $\pm$ 10%             | 2.52M                 | 0.19                  | 0.95                |
| S0606-470KR87-1F | 47 $\pm$ 10%             | 2.52M                 | 0.23                  | 0.87                |
| S0606-560KR80-1F | 56 $\pm$ 10%             | 2.52M                 | 0.26                  | 0.80                |
| S0606-680KR72-1F | 68 $\pm$ 10%             | 2.52M                 | 0.28                  | 0.72                |
| S0606-820KR66-1F | 82 $\pm$ 10%             | 2.52M                 | 0.39                  | 0.66                |
| S0606-101KR59-1F | 100 $\pm$ 10%            | 1K                    | 0.43                  | 0.59                |
| S0606-121KR54-1F | 120 $\pm$ 10%            | 1K                    | 0.54                  | 0.54                |
| S0606-151KR48-1F | 150 $\pm$ 10%            | 1K                    | 0.64                  | 0.48                |
| S0606-181KR44-1F | 180 $\pm$ 10%            | 1K                    | 0.74                  | 0.44                |
| S0606-221KR40-1F | 220 $\pm$ 10%            | 1K                    | 0.96                  | 0.40                |
| S0606-271KR36-1F | 270 $\pm$ 10%            | 1K                    | 1.12                  | 0.36                |
| S0606-331KR33-1F | 330 $\pm$ 10%            | 1K                    | 1.48                  | 0.33                |
| S0606-391KR30-1F | 390 $\pm$ 10%            | 1K                    | 1.66                  | 0.30                |
| S0606-471KR27-1F | 470 $\pm$ 10%            | 1K                    | 1.91                  | 0.27                |
| S0606-561KR25-1F | 560 $\pm$ 10%            | 1K                    | 2.31                  | 0.25                |
| S0606-681KR23-1F | 680 $\pm$ 10%            | 1K                    | 2.67                  | 0.23                |
| S0606-821KR21-1F | 820 $\pm$ 10%            | 1K                    | 3.10                  | 0.21                |
| S0606-102KR19-1F | 1000 $\pm$ 10%           | 1K                    | 4.45                  | 0.19                |



RoHS Compliant

NOTE : Specifications subject to change without notice. Please check our website for latest information.

04.09.2006



TAI-TECH ADVANCED ELECTRONICS (S) PTE LTD

# SPECIFICATION FOR APPROVAL

|                   |                               |      |   |
|-------------------|-------------------------------|------|---|
| Product Name      | RADIAL CHOKE COIL (LEAD FREE) | Page | 3 |
| Tai-Tech Part No. | S0606-1 STAND-OFF SERIES      |      |   |

## 6. CHARACTERISTICS CURVES :

@ TEMP. RISE VS. DC SUPERPOSITION RESPONSE CURVE

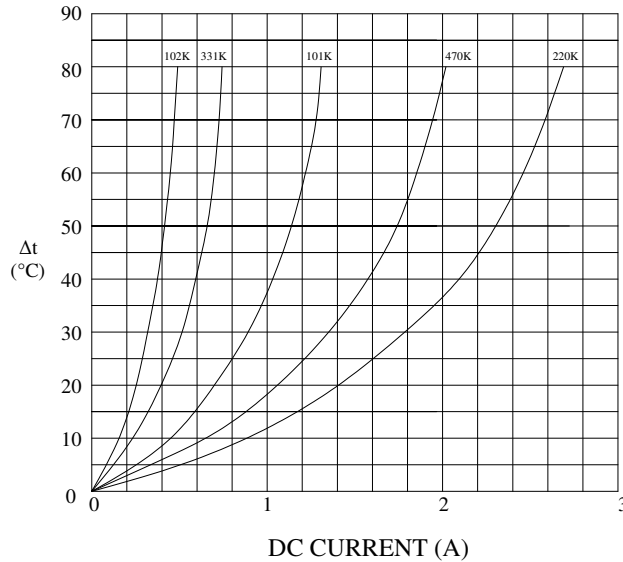

@ INDUCTANCE VS. FREQUENCY RESPONSE CURVE

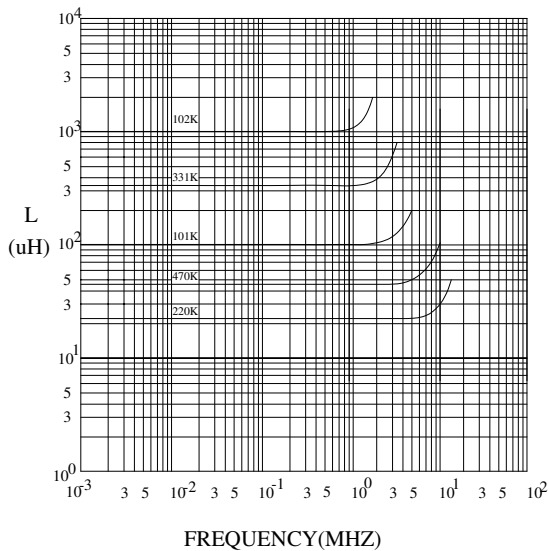

@ INDUCTANCE VS. DC SUPERPOSITION RESPONSE CURVE

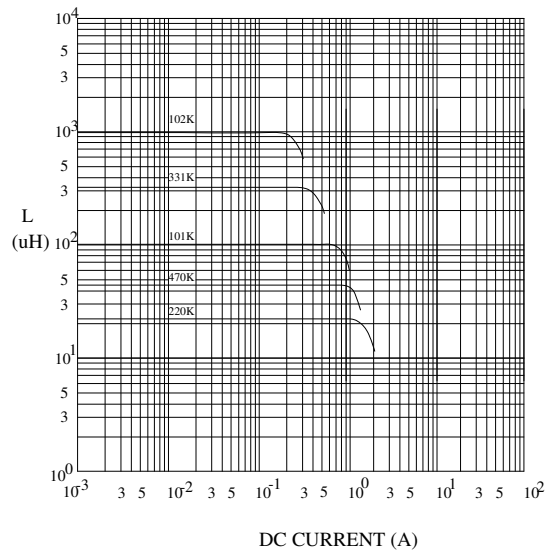

**RoHS Compliant**

NOTE : Specifications subject to change without notice. Please check our website for latest information.

04.09.2006



**TAI-TECH ADVANCED ELECTRONICS (S) PTE LTD**